

Degelman

**SEQUENCE VALVE
UPGRADE KIT**

LANDROLLER | LRX

EXTREME DUTY • POWER FOLD • ZERO MAINTENANCE

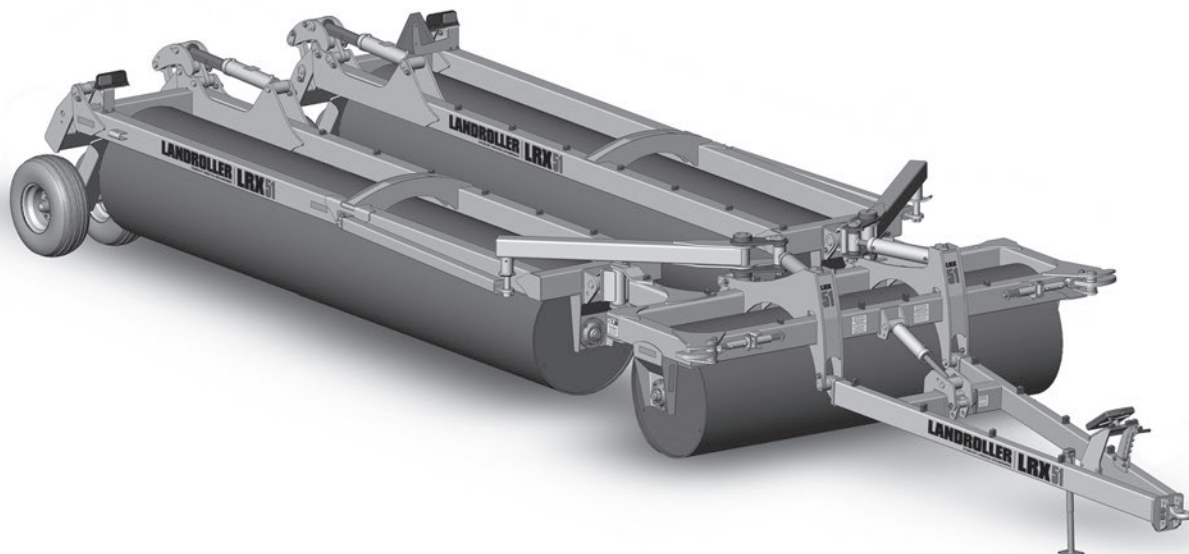
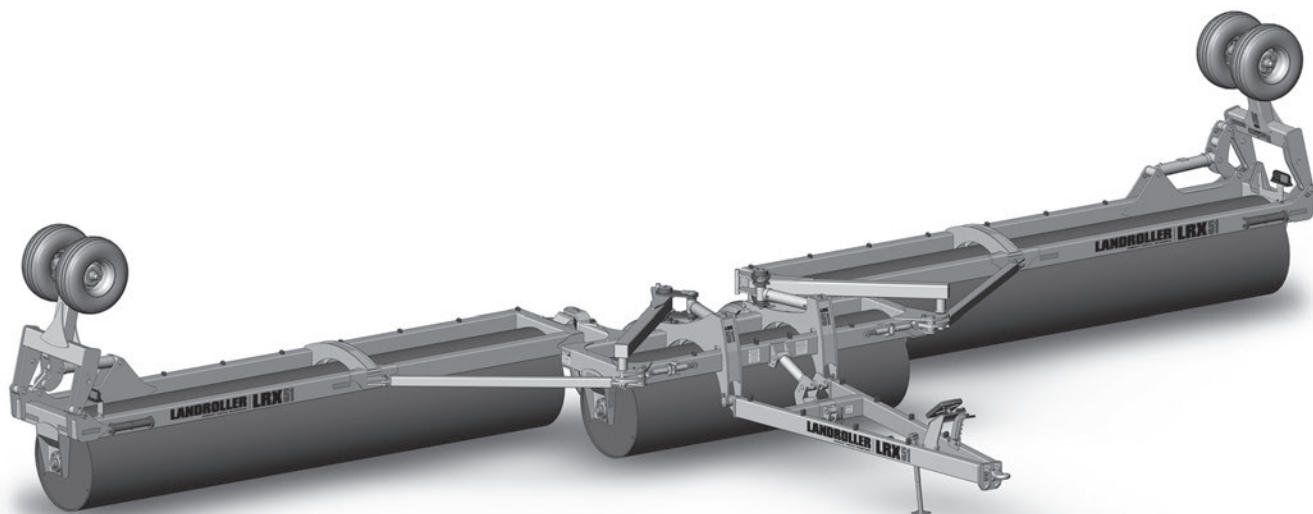

LRX36|41|46|51

143379 v1.1

DEGELMAN INDUSTRIES LTD.

BOX 830-272 INDUSTRIAL DRIVE,
REGINA, SK, CANADA, S4P 3B1
FAX 306.543.2140 PH 306.543.4447
1.800.667.3545 DEGELMAN.COM

**LANDROLLER
LRX
LRX 36/41/46/51**

Introduction

LRX36|41|46|51

SEQUENCE VALVE UPGRADE OVERVIEW

A sequencing valve upgrade has been introduced to the LRX Landrollers that helps simplify the Power-Fold process of opening and closing the LRX into and out of field position. It combines all three operations for raising/lowering the End Wheels, closing/opening the swing arm Latches, and Power-Folding the Swing Arms into and out of field position.

This insert sheet will help step you through the change-over process. The required changes will include:

- Preparing and welding (2) threaded Bosses on frame for mounting the new Sequence Valve Assembly.
- Assembling Hyd Fittings to new Sequence Valve, installing onto new Base Plate and then onto the frame.
- Removing a few of the existing Hoses, re-routing new Hoses, and updating some Hyd Clamps.
- Installing the cover over the Sequence Valve Assembly.
- Installing/replacing a few of the Decals.

List of Kit Components

- 141724 - Sequence Valve Assembly (1)
- 242838 - Sequence Valve Base Plate (1)
- 242839 - Sequence Valve Cover (1)
- 782389 - Boss, 1 OD x 1-1/2 (2)
- 142996 - Decal, Hyd Hose Label (1)
- 143368 - Decal, Important - Cyl Retract (1)
- 126771 - Hose, 3/8 x 24 - 1/2 ORFS F-SW (2)
- 242906 - Hose, 3/8 x 56 - 1/2 ORFS F-SW (3)
- 126772 - Hose, 3/8 x 68 - 1/2 ORFS F-SW (1)
- 242907 - Hose, 3/8 x 72 - 1/2 ORFS F-SW (2)
- 126713 - Hose, 3/8 x 56 - 1/2 ORFS x 1/2 F-90D (1)
- 126773 - Hose, 3/8 x 74 - 1/2 ORFS x 1/2 F-90D (1)
- 242958 - Bag, Hyd Fittings (1)
 - 141704 - Elbow, 90 (4)
 - 141703 - Nipple (2)
 - 141727 - Tee, M x F-SW x M (2)
 - 141728 - Tee, M x M x F-SW (2)
- 242959 - Bag, Hardware (1)
 - 118144 - Bolt, 5/16 x 1-1/2 (10)
 - 117517 - Bolt, 5/16 x 3-1/4 (2)
 - 118538 - Flat washer, 5/16 (2)
 - 118530 - Lock washer, 5/16 (2)
 - 118427 - Nut, 5/16 (2)
 - 118003 - Bolt, 3/8 x 3/4 (2)
 - 118511 - Flat washer, 3/8 (4)
 - 118417 - Lock Nut, 3/8 (2)
 - 118605 - Bolt, 5/8 x 1 (2)
 - 118508 - Lock washer, 5/8 (2)
 - 118537 - Flat washer, 5/8 F436 (2)

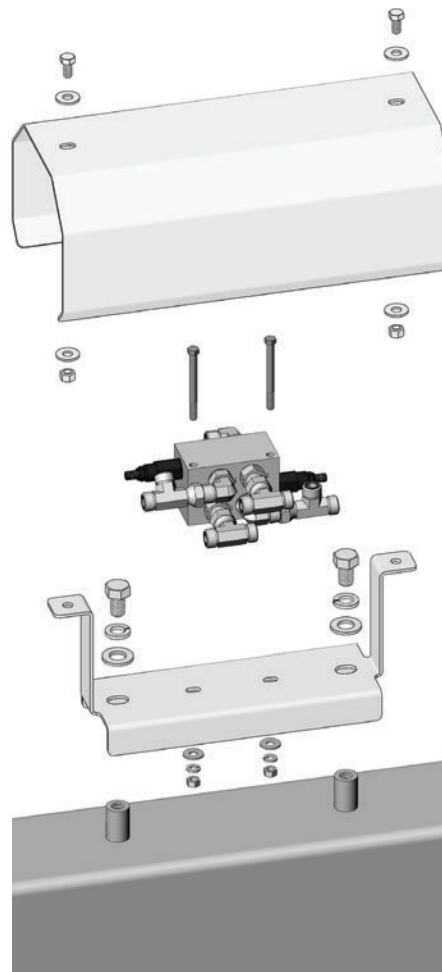

Rework - Hydraulic Layout - Latch & End Wheels

- 1 Remove the front connection fitting groups by unthreading the adaptor (5) from the hoses (96). These fittings, with the green couplers, can remain assembled to each other to be used in the new circuit arrangement. Set aside for the moment.

- 2 Remove the front hoses (96 x2), front tees (7 x2), hoses (144 x4), remove all four shorter hoses (44), and remove two of the four tees (7) on one side only, as the other two will be used to reconnect. Keep two of the shorter hoses (44) to be used in the new arrangement.

- 3 The swing arm latch cylinder fittings (8 x4) and the longer hoses that run to the endwheel cylinders shall remain in place.





Leave two tees attached to Endwheel Hoses

- 7  141712 - Tee, 1/2 ORFS M x M x M (2)





2 Hoses to Save & Re-use

- 44  242903 - Hose, 3/8 x 44 (2)

1 Remove but save to Re-use

- 1  141581 - Coupler Tip, 3/4 ORB F (2)
 2  141676 - Connector, 3/4 ORB M x M (2)
 3  141684 - Coupler, Green (+) (1)
 4  141685 - Coupler, Green (-) (1)
 5  141703 - Adaptor, 1/2 ORB M x ORFS M (2)

2 Hoses & Tees to Remove

- 96  242909 - Hose, 3/8 x 96 (2)
 144  242910 - Hose, 3/8 x 144 (4)
 44  242903 - Hose, 3/8 x 44 (2)
 7  141712 - Tee, 1/2 ORFS M x M x M (4)

3 Remains in Place

Hose Wrap Hoses & Cable - 2 Locations

Required Hoses for Latch & End Wheel Cylinders

- 51' Models Only  398 242919 - Hose, 3/8 x 398 - 1/2 ORFS F-SW (1)
 51' Models Only  378 242918 - Hose, 3/8 x 378 - 1/2 ORFS F-SW (1)
 46' Models Only  368 242917 - Hose, 3/8 x 368 - 1/2 ORFS F-SW (1)
 46' Models Only  348 242916 - Hose, 3/8 x 348 - 1/2 ORFS F-SW (1)
 41' Models Only  338 242915 - Hose, 3/8 x 338 - 1/2 ORFS F-SW (1)
 41' Models Only  318 242914 - Hose, 3/8 x 318 - 1/2 ORFS F-SW (1)
 36' Models Only  308 242913 - Hose, 3/8 x 308 - 1/2 ORFS F-SW (1)
 36' Models Only  288 242912 - Hose, 3/8 x 288 - 1/2 ORFS F-SW (1)

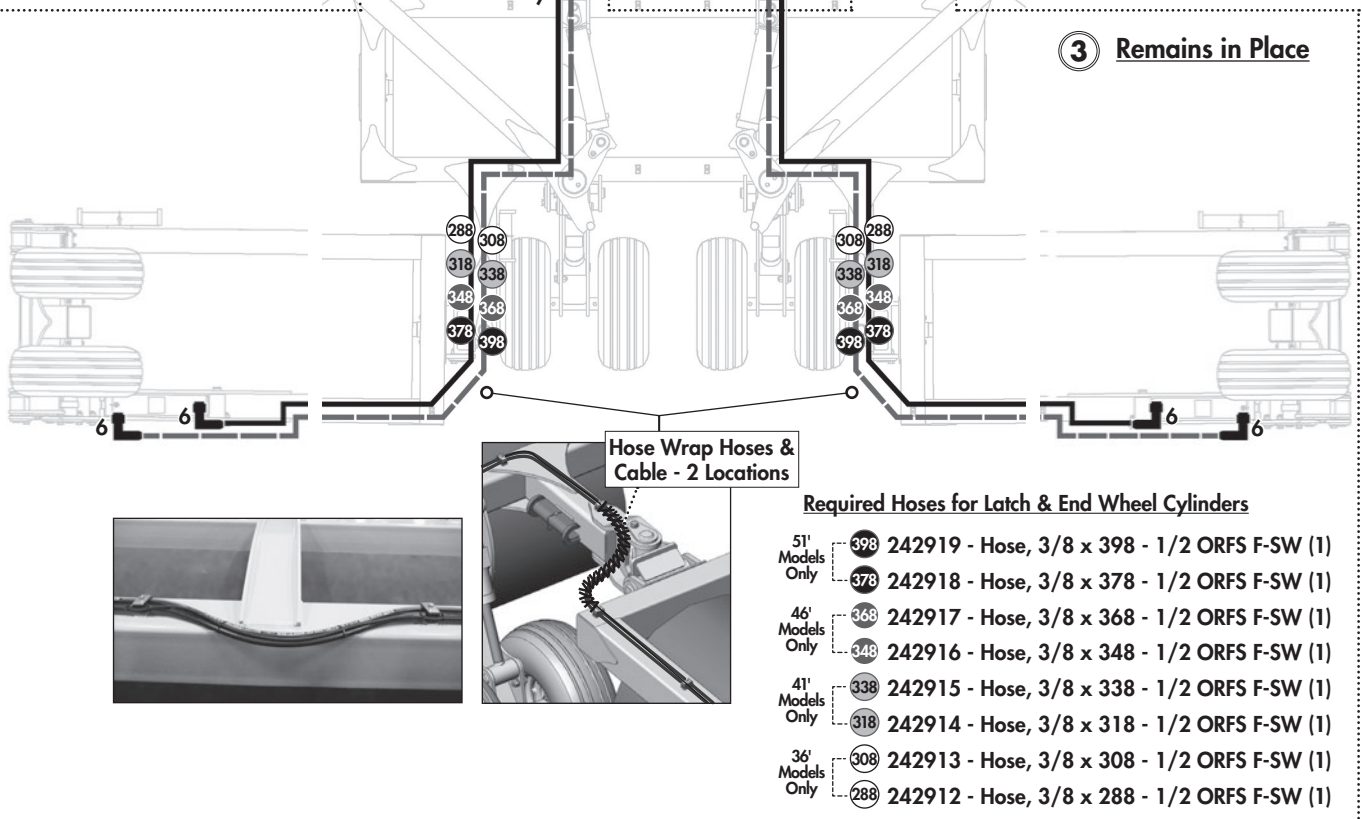

Rework - Hydraulic Layout - Power-fold

- ④ Remove the front connection fitting groups by unthreading the adaptor (5) from the hoses (240). Replace these fittings, with the Green couplers fitting assemblies saved from **Step 1** - (Note: Save the Blue coupler ends to replace the Brown coupler ends on the Center Wheels & Float Circuit.)

- ⑤ Remove hoses (84 x2) & hoses (36 x2). The tees (7 x2) can remain attached to the hoses (240) and will be reused. All elbow fittings (6 x4) on the Power-fold cylinders shall remain in place.

- ⑥ The Hydraulic hoses and components for the Center Wheels & Float circuit remain unchanged except for replacing the Brown coupler ends with the Blue coupler ends removed in **Step 4**.

IMPORTANT - The Orifice (9) needs to be removed and is no longer used.

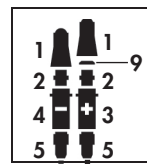

✗ (Note: Save the Blue coupler ends to replace the Brown coupler ends on the Center Wheels & Float Circuit.)

IMPORTANT - The Orifice (9) needs to be removed and is no longer used.)

④ Remove and Replace

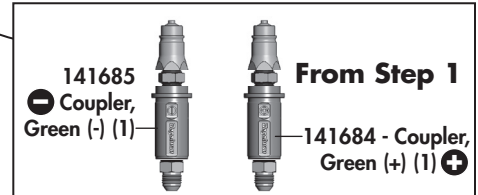

⑤ Remove Hoses Only

⑧4 242908 - Hose, 3/8 x 84 (2)

③6 242902 - Hose, 3/8 x 36 (2)

Remain in Place

②40 242911 - Hose, 3/8 x 240 (2)

6 141704 - Elbow, 90° (4)

7 141712 - Tee (2)

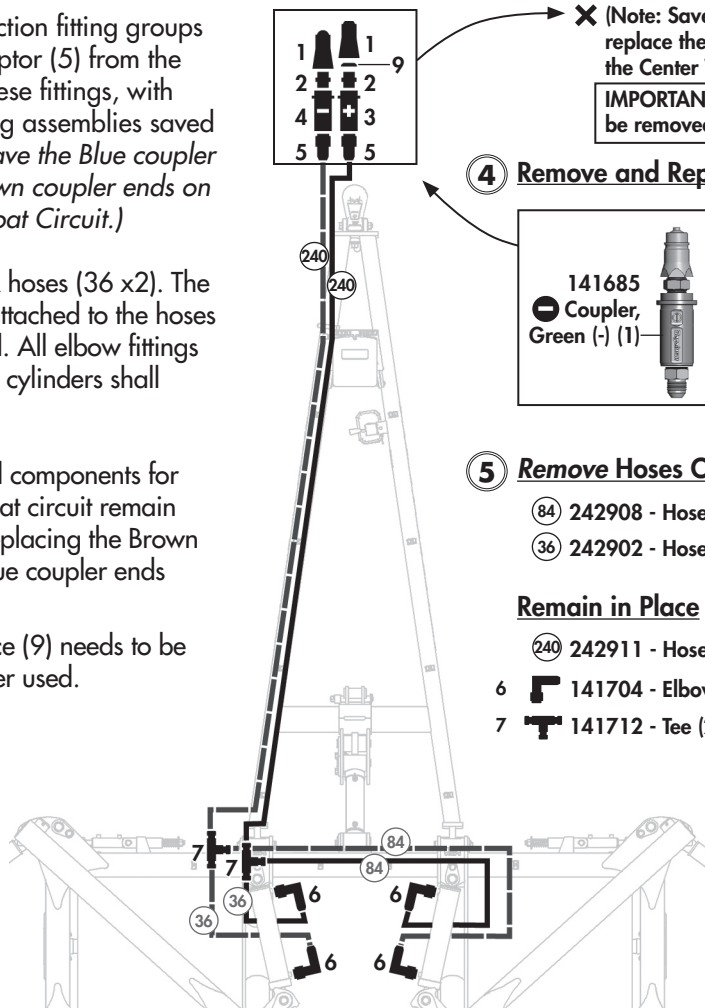

Rework - Prep & Weld Threaded Bosses onto Frame

- ⑦ The two threaded bosses (782389) need to be welded onto the front tubing of the center frame. The bosses should be centered on tube as well as possible with a distance of 10" center-to-center apart from each other.

You will need to prepare the surface by grinding the paint from surface of tube before welding.

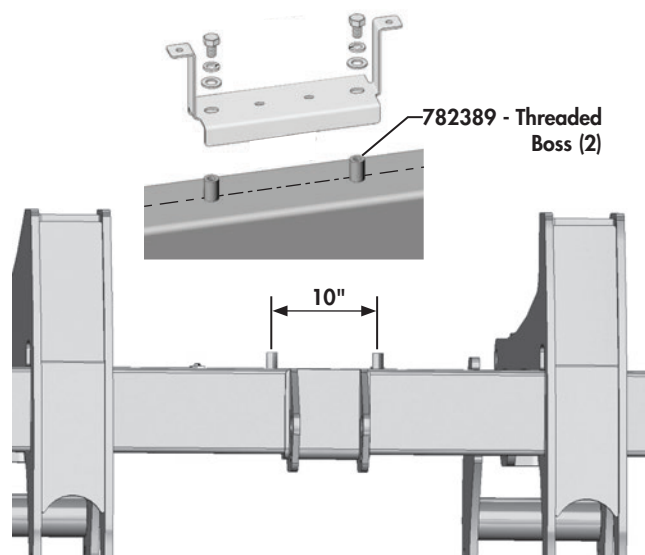

Sequence Valve Assembly

- ⑧ Assemble the hydraulic fittings into the Sequence valve as shown:

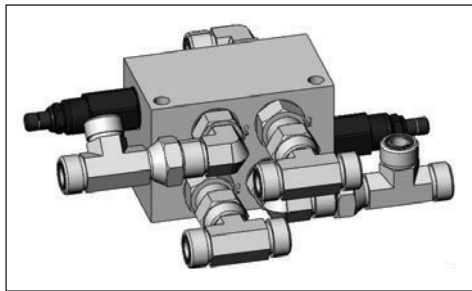

141724 - Sequence Valve Assembly (1)

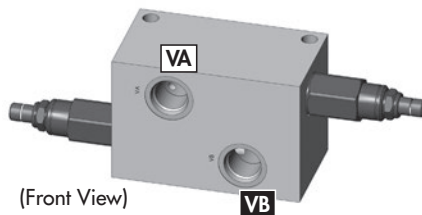
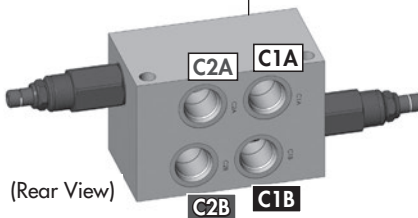

Sequence Valve Fitting Connection Overview

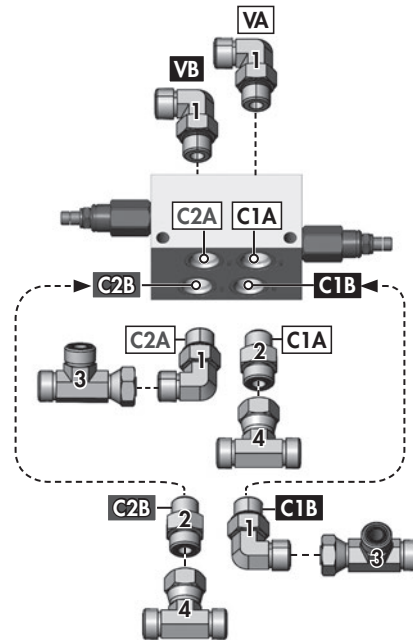

Hydraulic Fittings Required - Sequence Valve

- | | | | |
|---|--|--|-----|
| 1 | | 141704 - Elbow, 90° 1/2 ORB M x ORFS M | (4) |
| 2 | | 141703 - Adaptor, 1/2 ORB M x ORFS M | (2) |
| 3 | | 141727 - Tee, 1/2 ORFS M x F-SW x M | (2) |
| 4 | | 141728 - Tee, 1/2 ORFS M x M x F-SW | (2) |

- ⑨ Assemble the Sequence Valve onto the Base Plate as shown:

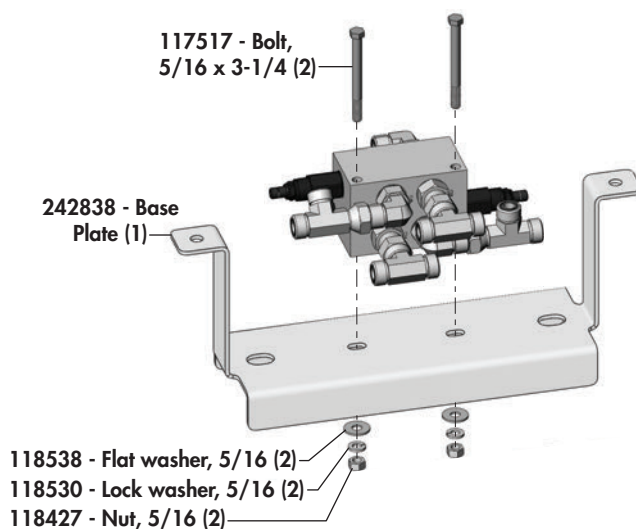

- ⑩ Assemble the Sequence Valve Base Plate onto the new Threaded Bosses as shown:

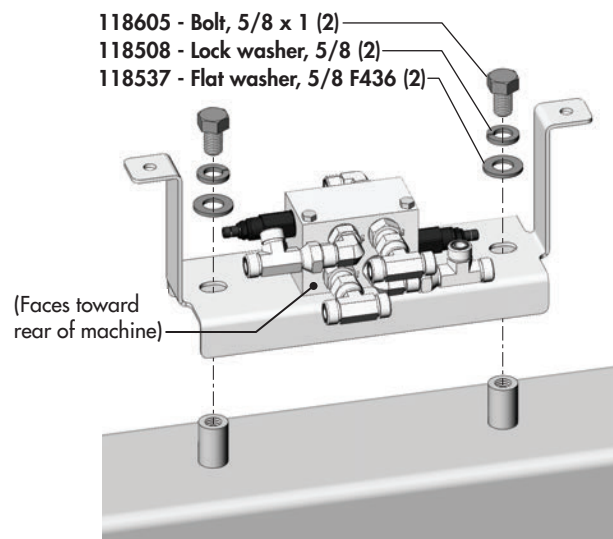

Hydraulic Routing - Latch, End Wheel, & Swing Arm

11 Re-assembly of Existing Hydraulic Hoses

Connect the two *removed* hoses (44) from **Step 2** in between the two tees (7) of the *existing* front hoses (240) to the two tees (7) of the *existing* Endwheel Hoses.

Connect the other set of Endwheel hoses to these rear tees as well (see diagram).

Note: Excess length in these hoses can be bundled up near center strut cylinders (refer to photo at bottom of page)

240 242911 - Hose, 3/8 x 240 - 1/2 ORFS F-SW (2)

44 242903 - Hose, 3/8 x 44 - 1/2 ORFS F-SW (2)

12 Install New Hoses

Connect the **new** supplied hoses between the cylinders, hoses, and the sequence valve as shown in the diagrams.

74 126773 - Hose, 3/8 x 74 - 1/2 ORFS x 1/2 F-90D (1)

72 242907 - Hose, 3/8 x 72 - 1/2 ORFS F-SW (2)

68 126772 - Hose, 3/8 x 68 - 1/2 ORFS F-SW (1)

56 126713 - Hose, 3/8 x 56 - 1/2 ORFS x 1/2 F-90D (1)

56 242906 - Hose, 3/8 x 56 - 1/2 ORFS F-SW (3)

24 126771 - Hose, 3/8 x 24 - 1/2 ORFS F-SW (2)

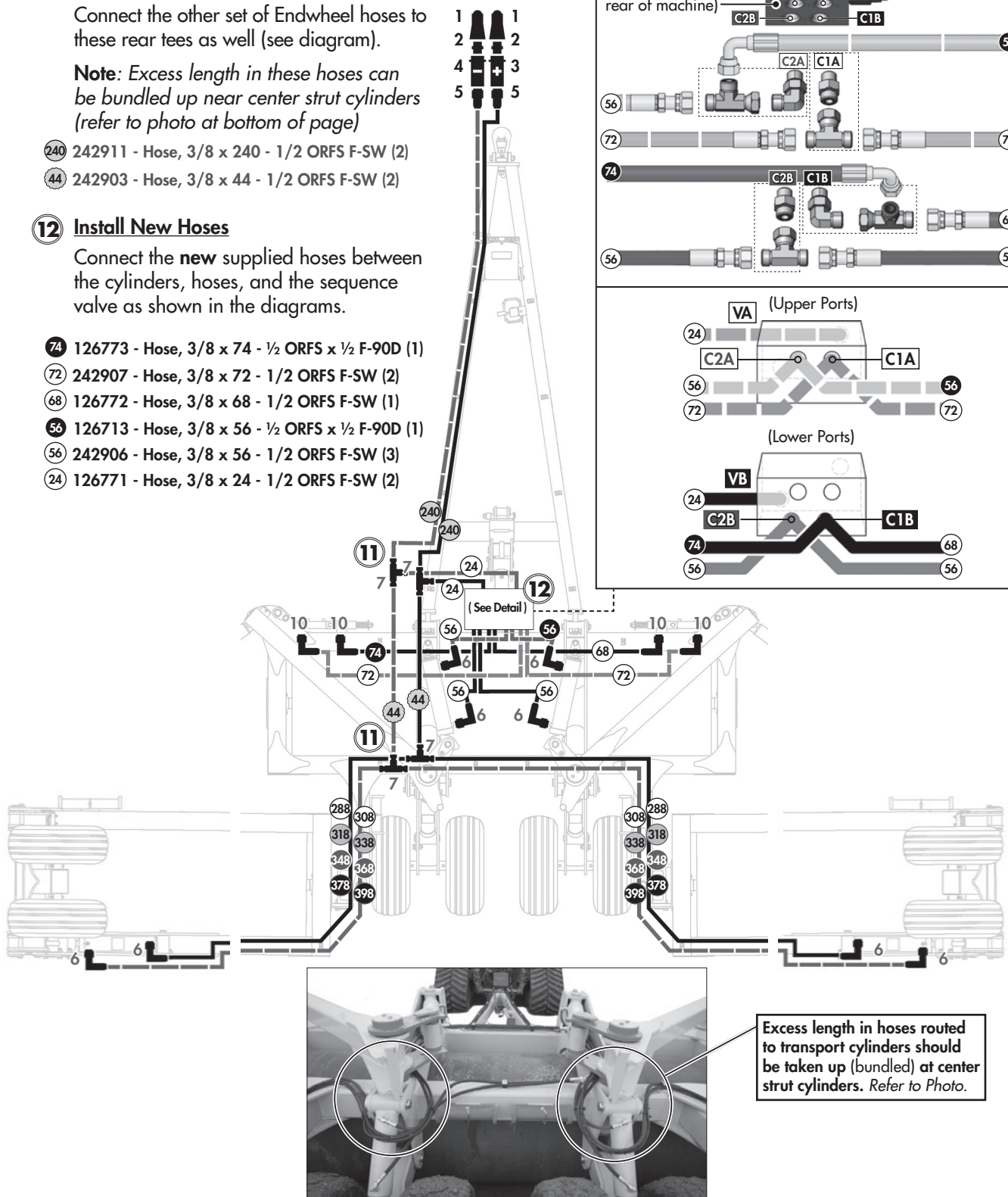
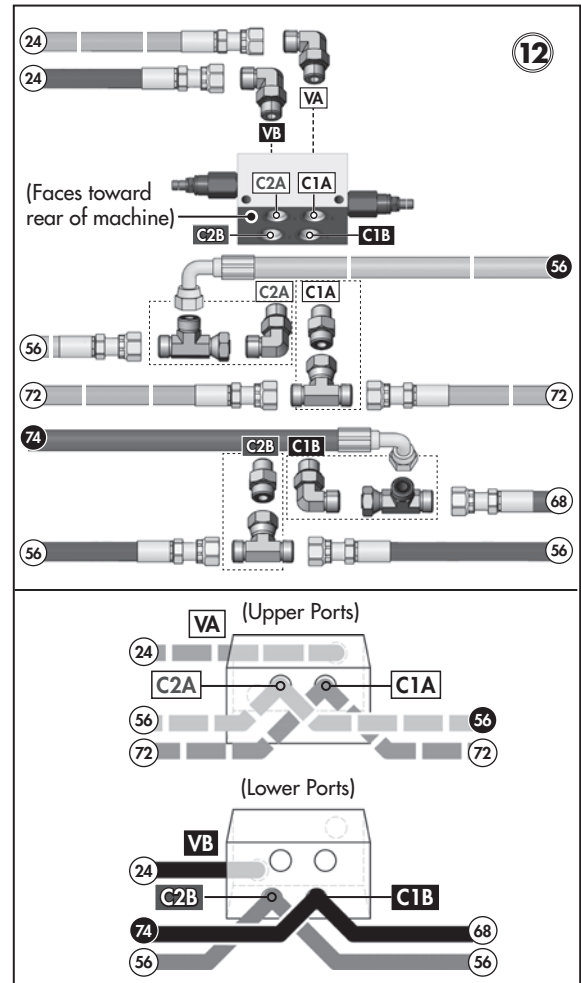

Excess length in hoses routed to transport cylinders should be taken up (bundled) at center strut cylinders. Refer to Photo.

Install Cover, Update Hyd Clamps & Decals

13 Install Sequence Valve Cover

- Install Sequence Valve Cover using the included hardware as shown in diagram.

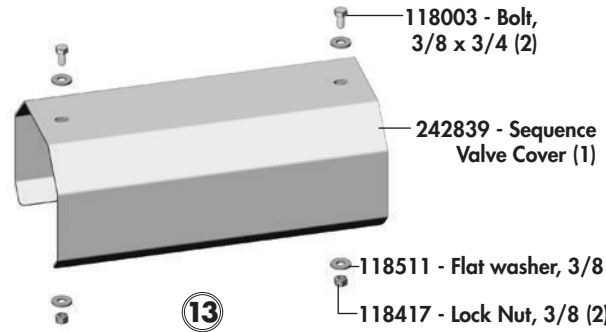

14 Replace and Install Hose Clamps

- Remove Double Hose clamps (B) on Hitch pole and replace with Single Hose clamp (A) configuration. New bolts (118144) are provided for these single hose clamps.
- Replace the Double Hose clamps (B) on rear center frame with Single Hose clamp (A) configuration.
- Replace the two Single Hose clamps (A) on rear center frame with Double Hose clamp (B) configurations. Use two of the longer bolts (118105) removed from the previous hitch pole clamp configuration.

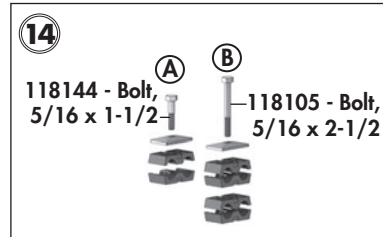
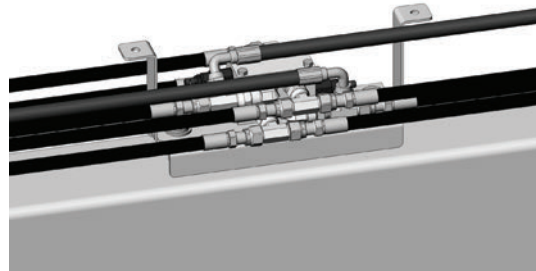

15 Install / Remove / Replace Decals

- Remove and replace previous hydraulic hose label decal with the new decal (142996 - Decal, Hyd Hoses Label).
- Install the new decal (143383 - Decal, Important - Retract Cylinder) over top of the previous decal as shown below.
- Remove previous decal (142992 - Decal, Important Retract Powerfold) as shown below.

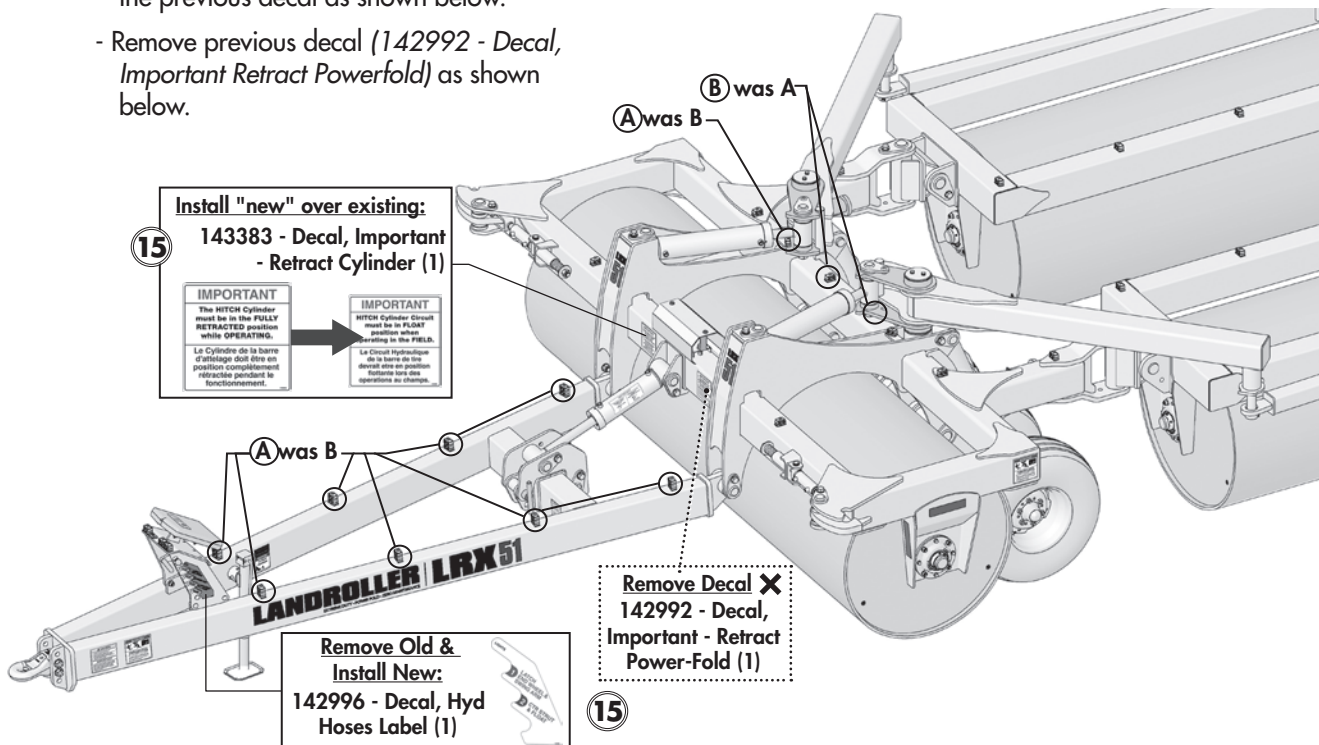

QUICK-START GUIDE* for LRX LANDROLLERS

* Refer to operators manual for complete safety and operation info.



Degelman

A Connect Hydraulics

① LATCH, END WHEEL & SWING ARM.....Cylinders

② CTR WHEEL & FLOAT....Hitch & Center Wheel Cylinders

B Opening into Field Position

1) Drive the **LRX Landroller** onto an area of level ground large enough to open the wings. Ensure the Landroller is positioned straight behind the tractor.

2) Remove the four **Red Transport Bars** from the End Wheel & Center Wheel cylinders. Place the transport bars onto the frame mounted storage brackets and secure with the lock-pins.

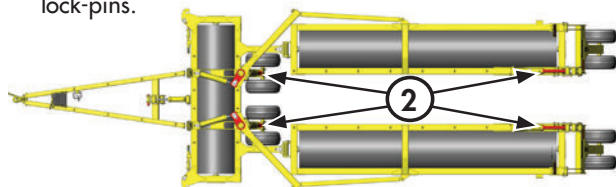

Note: You may need to activate (extend) the hydraulic cylinders slightly to allow easier removal of the cylinder Transport Bars.

3) Activate the ① **End Wheel, Power-fold, and Latch circuit** to completely raise the **End Wheels** and lower the ends of the wing roller drums to the ground.

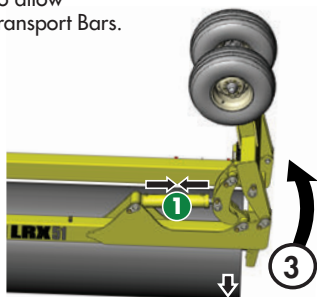

4) Continue activating this circuit ① to fully extend the **Power-fold Cylinders** and open the wings. Ensure both of the Swing-Arm shafts latch properly into place.

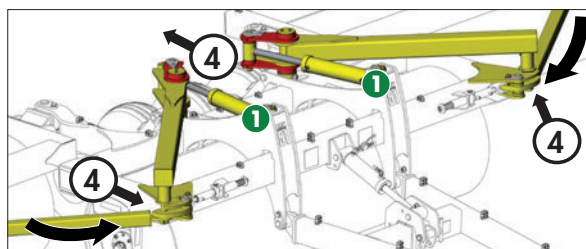

5) Retract the **Center Frame Cylinders** ② to raise the center frame wheels (lowering the center section to the ground).

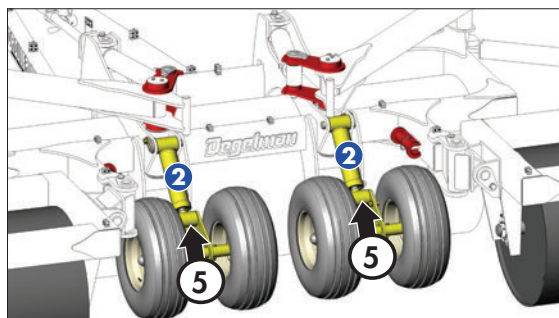

6) Remove the **Red Transport Pin** from the float hitch and secure it in storage position.

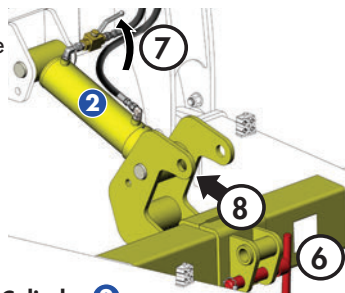

7) Open the **Hydraulic Ball Valve**.

8) Fully Retract the **Hitch Cylinder** ② to place the Landroller into Float Position.

9) The LRX Landroller should now be in the proper position for field use. Read manual for further information.

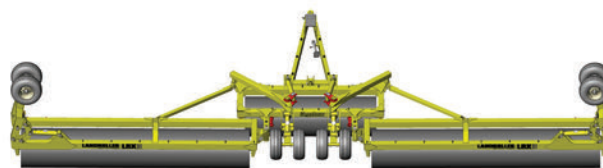

(Refer to operators manual for complete safety and operation info.)



Maintenance (Check Machine Daily)

- Check for missing, worn or damaged parts.
- Working points & pins
- Hydraulic Connections & Hoses
- Hubs & Spindles

C Moving Into Transport Position

- 1) Drive the **LRX Landroller** onto an area of level ground with plenty of room to drive straight forward.

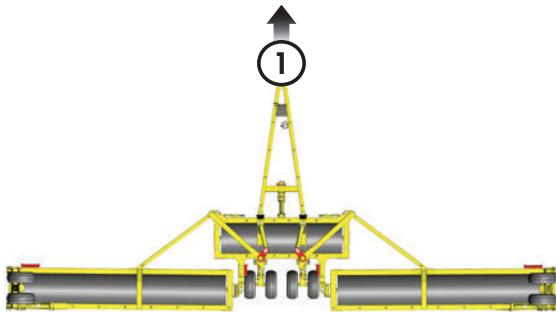

- 2) Fully extend the **Front Hitch & Center Frame Cylinders** **2**.

This places the float hitch into **Transport Position** and also fully lowers the Center Frame Wheels (raising the center section off the ground).

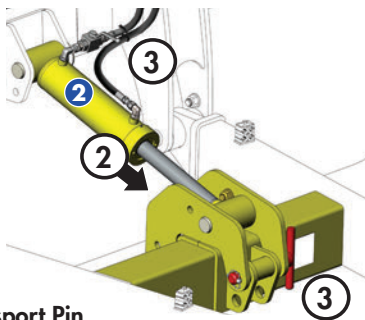

3) **IMPORTANT:**

- Secure the **Float Hitch** in place with the **Red Transport Pin**.
- Close the **Hydraulic Ball Valve**.

- 4) Activate the **1 End Wheel, Power-fold, and Latch circuit**.

Since this is a combined circuit, the **Power-fold** cylinders will start to retract and the **End Wheels** may start to lower at the same time.

When the **Power-fold** cylinders are retracted the pressure will increase enough to activate the **Latch Cylinders**.

Continue to activate **1** until *both* **Latches** are open, the **Power-fold** cylinders are *fully* retracted and the **End Wheels** have been *fully* lowered raising the drums off the ground.

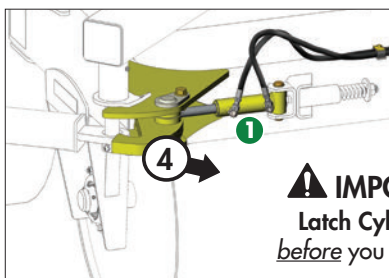
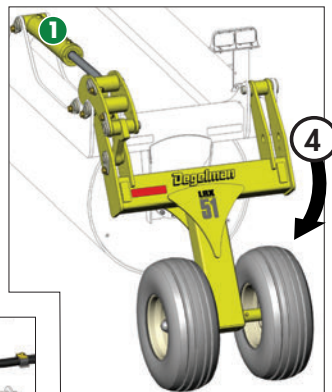
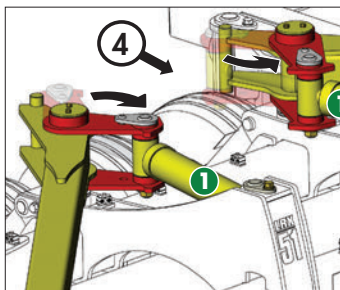

IMPORTANT: Ensure *both* **Latch Cylinders** are **Fully Open** *before* you begin to drive forwards.

IMPORTANT:

Ensure the **Power-fold Cylinders** are **Fully Retracted** before you begin to drive forwards.

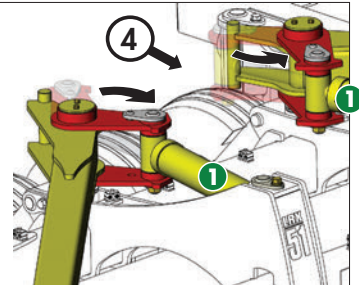

- 5) Drive forwards until drums trail behind center frame.
Ensure **End Wheels** **1** are fully lowered into transport position.

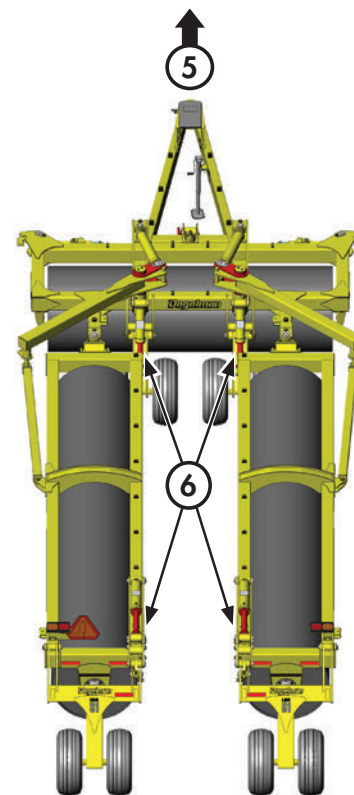

- 6) Install the four **Red Transport Bars** onto the **End Wheel & Center Wheel** cylinder shafts and secure in place using the lock-pins.

Ensure front **Red Transport Pin** has also been installed correctly into the float hitch (refer to step 3).

- 7) Read and follow necessary safety procedures outlined in Transport Safety section of the manual.

